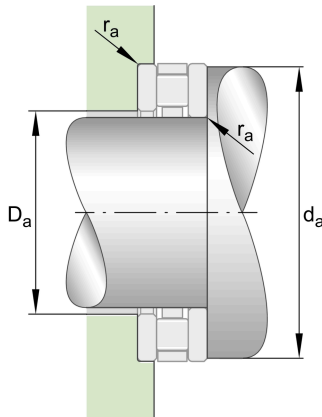
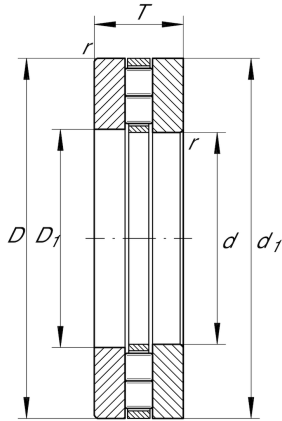
**89306-TV**

Axial cylindrical roller bearing

Schaeffler ID:
0003617800000Axial cylindrical roller bearings 893, single
direction, comprising K893, GS, WS

Technical information

**Main Dimensions & Performance Data**

d	30 mm	Bore diameter
D	60 mm	Outside diameter
T	18 mm	Height
C_a	69,000 N	Basic dynamic load rating, axial
C_{0a}	197,000 N	Basic static load rating, axial
C_{ua}	19,200 N	Fatigue load limit, axial
n_G	6,400 1/min	Limiting speed
n_{gr}	2,600 1/min	Reference speed
	0.002 kg	Weight

Dimensions

	K89306-TV	Axial roller and cage assembly
D_1	32 mm	Bore diameter housing washer
	GS89306	Housing Washer
d_1	60 mm	Rip diameter shaft washer
	WS89306	Shaft washer
B	18 mm	Width
r_{min}	1 mm	Minimum chamfer dimension
D_{c1}	60 mm	Cage bore diameter

Mounting dimensions

d_a	59 mm	Minimum diameter shaft shoulder
D_a	33 mm	Maximum diameter of housing shoulder
r_a	1 mm	Recess radius